

Section BB
Scale 1:125

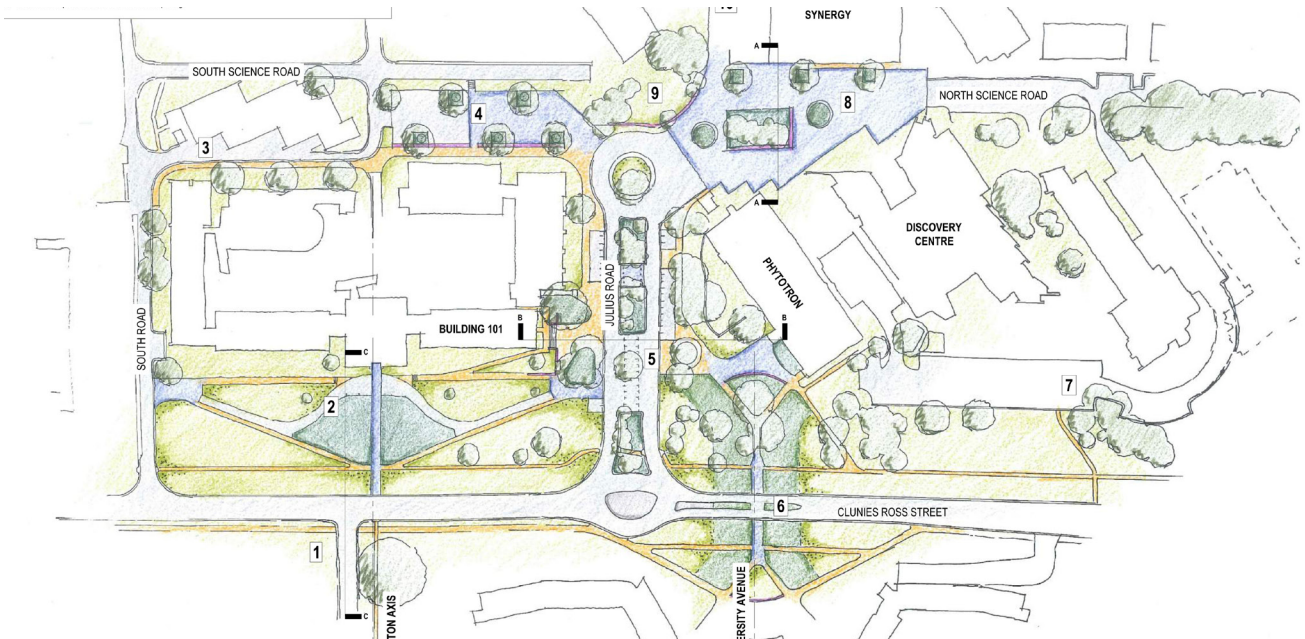
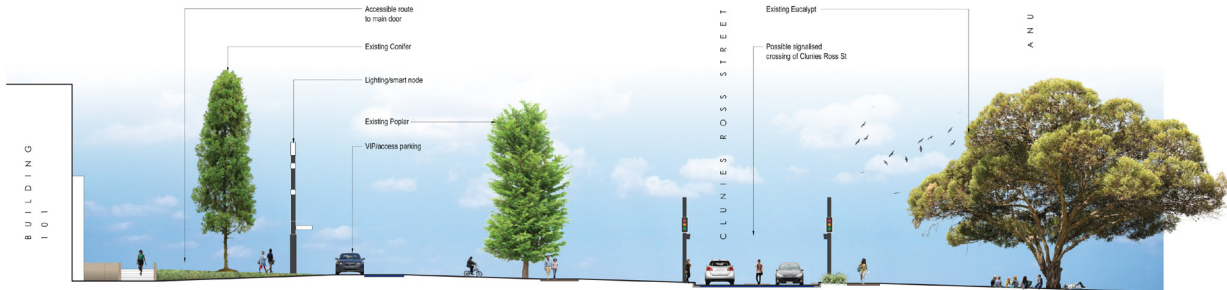

BLACK MOUNTAIN OUTDOOR AREA

The CSIRO is a world-renown scientific research organisation and an iconic Australian institution. The Black Mountain campus is similarly iconic, with its dramatic setting and its close relationship the neighbouring Australian National University.

COMPLETE was commissioned to design that part of the site which overlooks the ANU in order to form a stronger physical connection to reflect the research links which already exist. The planning also identified where a true pedestrian heart to the campus should be and how it would be arranged. These tasks involved re-considering traffic and access across the whole site and responding to the constraints imposed by the heritage values of buildings in the area.

LOCATION: Black Mountain, Canberra
PROJECT TYPE: Landscape Architecture
BUDGET: \$3 million
STATUS: Ongoing
ORGANISATION: CSIRO